

# noxar



## DIR-PRO

infrared illuminator 4-in-1

user manual version: **I 2024 EN**

## Product scheme

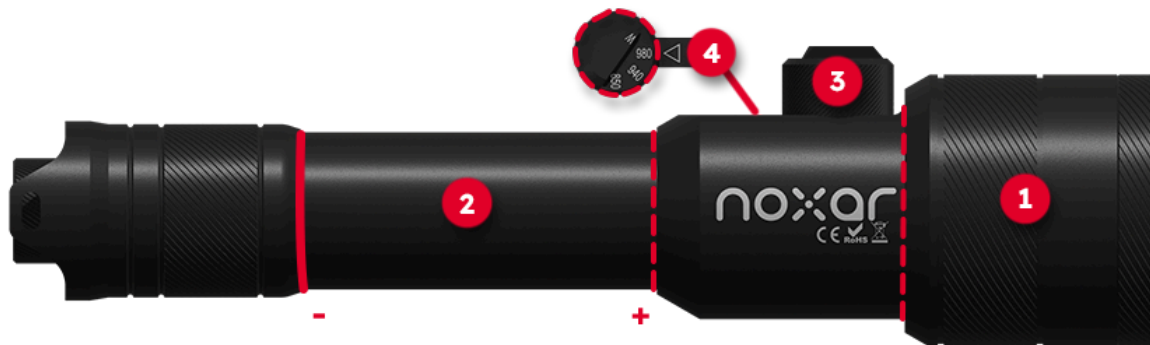

1	IR lens	4	Selected diode marker
2	Battery tray	5	Quiet button
3	Diode change knob	6	Status indicator



## Cautions & Description

- Do not look directly at the infrared light from the IR illuminator, as the highly focused beam can damage your eyesight! Keep out of the reach of children.
- The highly concentrated infrared beam can ignite flammable products from very close range in extreme cases, so do not leave or put the device in your pocket with the IR illuminator on. It is not recommended to use the IR illuminator continuously for more than 10-15 minutes. This can lead to overheating and damage to the laser diode and the illuminator lens.

**1.** The illuminator lens (1) has the ability to adjust the focus of the beam (the fully extended 'forward' lens is responsible for the maximum focus of the beam). Be careful and do not look directly at the illuminator beam - this can damage your eyesight.

**2.** To insert the battery, unscrew the sleeve of the battery tray (3), at the junction with the switch element (the junction place marked with a thick line). Place the 18650 battery with the positive pole facing the lens (diagram shown in the graphic). Note: Do not use adapters for batteries of other types.

**3.** To turn on the illuminator, screw on the sleeve of the battery tray and press the power button (5). A green glowing LED (6) indicates that the device is activated.

**4.** IR power is adjusted smoothly by using the knob located on the power button (5). To change the type of diode, use the top knob (3) and set the signature of the preferred diode on the knob in the direction of the arrow drawn on the illuminator (4).

## Model variants

Noxar DIR-PRO (980nm)	Noxar DIR-PRO (UV)
White LED	White LED
850 nm	850 nm
940 nm	940 nm
980 nm	UV LED

## Package contents:

Illuminator
18650 Noxar rechargeable battery
Charger
User Manual
Warranty Card

## WARNING!

The device is a precision electronic apparatus. Any repairs or modifications on your own may result in damage to the equipment or loss of warranty. The producer is not responsible for the consequences of using the device improperly and not in accordance with the instruction manual. Mechanical damage, breaking the warranty seals and stickers, and self-installing software may void the warranty. Each unit is marked with a unique serial number for identification.

**Read the user manual before using the equipment!**



### Remember!

The symbol of the crossed-out waste container informs about the prohibition of placing used electrical and electronic equipment together with other waste. Waste equipment should be collected selectively, the user is obliged to transfer the used equipment to a collection point to ensure recycling and recovery.

All rights reserved! Copying, reproduction and use of the manual and its parts without permission of the author is prohibited.