

# 4x15/4x20/3-7x20

OPERATING INSTRUCTIONS • BEDIENUNGSANLEITUNG • MODE D'EMPLOI • MANUAL DE INSTRUCCIONES



- |           |                       |           |                            |
|-----------|-----------------------|-----------|----------------------------|
| <b>EN</b> | 01 Ocular             | <b>FR</b> | 01 Oculaire                |
|           | 02 Reticle focusing   |           | 02 Mise au point réticule  |
|           | 03 Mount Lug screw    |           | 03 Montage vis de fixation |
|           | 04 Height adjustment  |           | 04 Réglage en hauteur      |
|           | 05 Windage adjustment |           | 05 Réglage latéral         |
|           | 06 Objective          |           | 06 Objectif                |
|           | 07 Reticle 8          |           | 07 Réticule 8              |
|           | 08 Tube lug screw     |           | 08 Tube vis de fixation    |

- |           |                           |           |                                 |
|-----------|---------------------------|-----------|---------------------------------|
| <b>DE</b> | 01 Okular                 | <b>ES</b> | 01 Ocular                       |
|           | 02 Scharfeinstellung      |           | 02 Enfoque reticula             |
|           | Absehen                   |           | 03 Montaje tornillo de fijación |
|           | 03 Montage Fixierschraube |           | 04 Ajuste en altura             |
|           | 04 Höhenverstellung       |           | 05 Ajuste lateral               |
|           | 05 Seitenverstellung      |           | 06 Objektiv                     |
|           | 06 Objektiv               |           | 07 Reticula 8                   |
|           | 07 Absehen 8              |           | 08 Tubo tornillo de fijación    |
|           | 08 Tubus-Fixierschraube   |           |                                 |

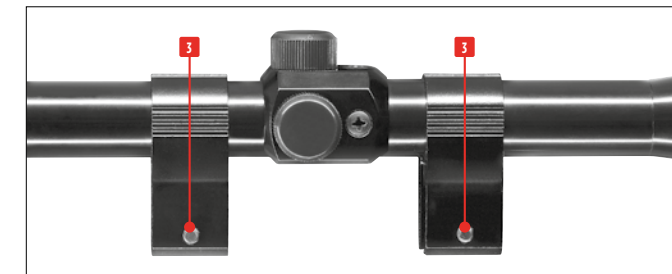
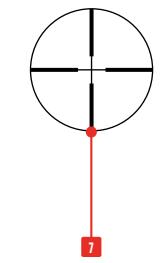
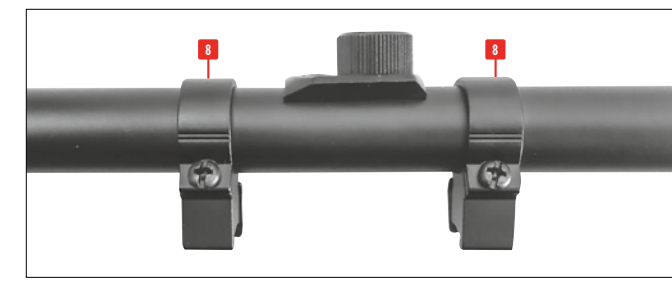
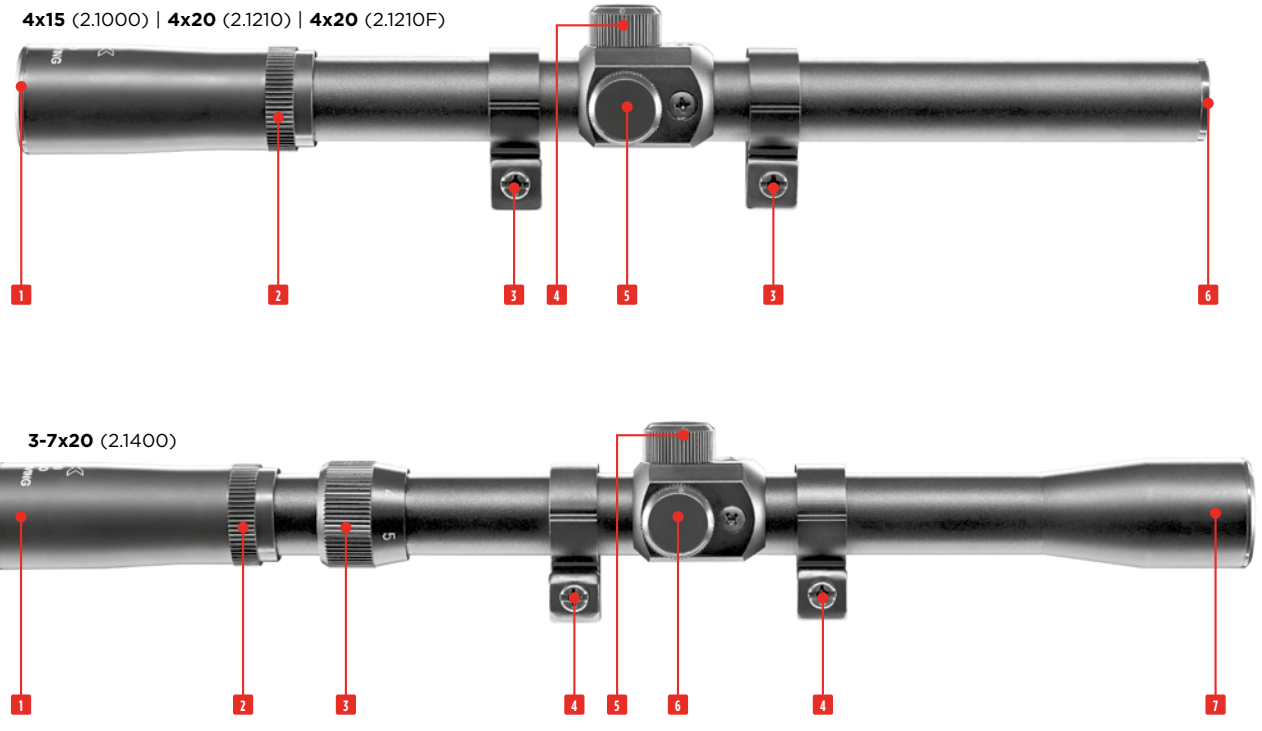

## ADJUSTMENT OF THE RETICLE • JUSTIERUNG DES ABSEHENS • RÉGLAGE DU RÉTICULE • AJUSTE DE LA RÉTICULA

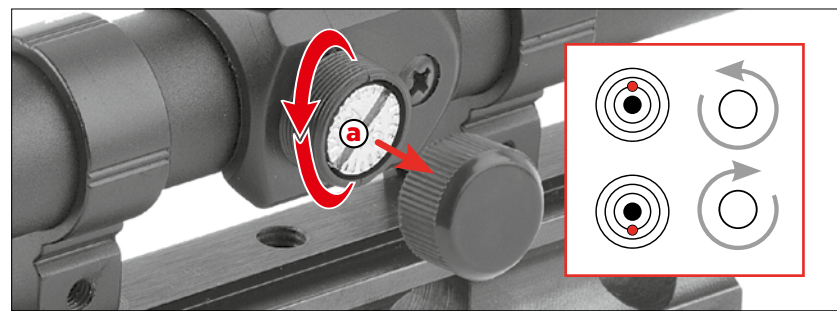
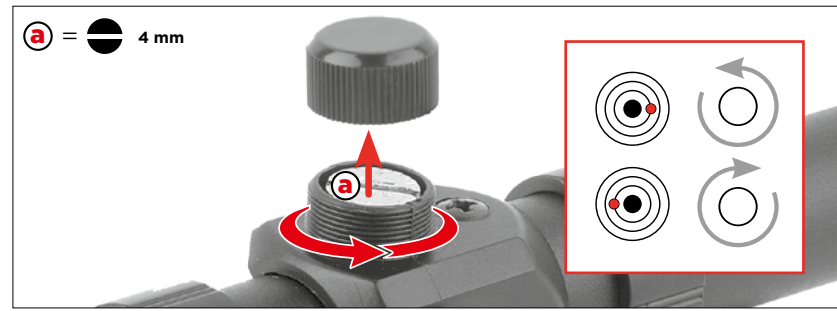

## OPERATION AND ADJUSTMENT • BEDIENUNG UND JUSTIERUNG • UTILISATION ET AJUSTAGE • MANEJO Y AJUSTE

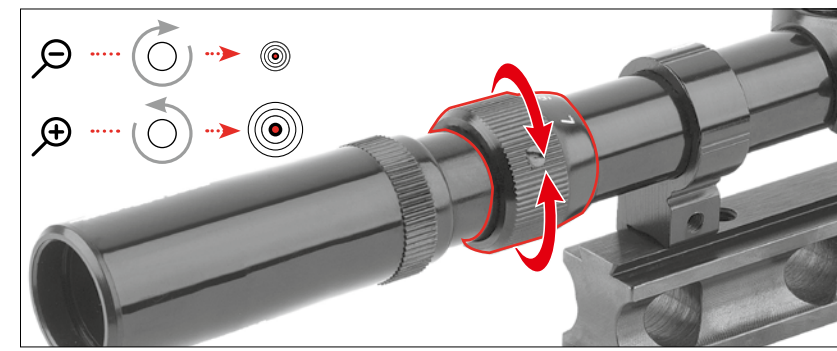
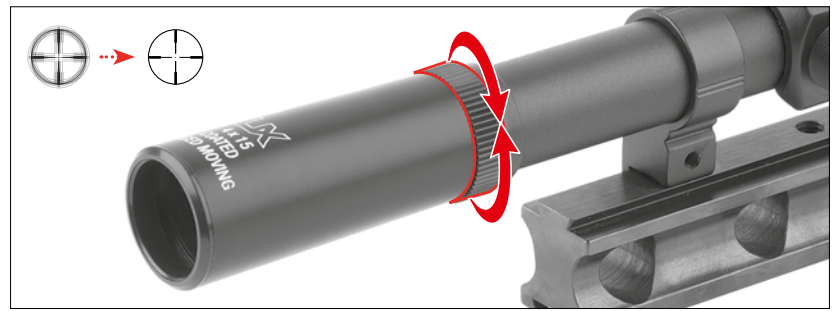

## TECHNICAL DATA • TECHNISCHE DATEN • DONNÉES TECHNIQUES • DATOS TÉCNICOS

	2.1000: 4x • 4-fach • 4 fois • 4 aumentos	2.1210/2.1210F: 4x • 4-fach • 4 fois • 4 aumentos	2.1400: 3x-7x • 3-fach - 7-fach • 3 fois - 7 fois • 3 aumentos - 7 aumentos
Magnification • Vergrößerung • Grossissement • Ampliación			
Objective lens diameter • Objektivdurchmesser • Diamètre de la lentille de l'objectif • Diámetro del objetivo	2.1000: 15 mm	2.1210/2.1210F: 20 mm	2.1400: 20 mm
Reticle • Absehen • Réticule • Reticula	8		
Weight including mount • Gewicht & Montage • Poids avec monture • Peso (incluida la montura)	2.1000: 95 g	2.1210/2.1210F: 100 g	2.1400: 147 g
Length • Länge • Longueur • Longitud	2.1000: 270 mm	2.1210/2.1210F: 267 mm	2.1400: 291 mm
Tube diameter • Rohrdurchmesser • Diamètre du canon • Diámetro tubular	19 mm		
Mount • Montage • Montage • Montaje	prism rail • Prismenschiene • Rail prismatique • Riel del prisma		
Parallax adjustment • Parallaxe einstellbar • Parallaxe variable • Paralaje variable	2.1000: 10 m	2.1210/2.1210F: 10 m	2.1400: 10 - ∞ m

# 4x15/4x20

OPERATING INSTRUCTIONS • BEDIENUNGSANLEITUNG • MODE D'EMPLOI • MANUAL DE INSTRUCCIONES

# 3-7x20

OPERATING INSTRUCTIONS • BEDIENUNGSANLEITUNG • MODE D'EMPLOI • MANUAL DE INSTRUCCIONES



## MOUNTING | MONTAGE | MONTAJE | MONTAGE

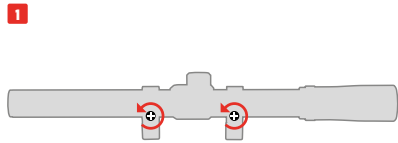

- EN** Slightly loosen the 2 tube lug screws
- DE** Die 2 Tubus-Fixierschrauben leicht lösen
- FR** Dévisser légèrement les 2 tube vis de fixation
- ES** Desatornillar ligeramente los 2 Tubo tornillo de fijación

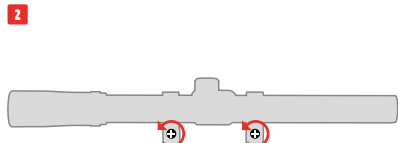

- EN** Unscrew mount lug screw
- DE** Lösen der Montage Fixierschraube
- FR** Dévisser les montage vis de fixation
- ES** Desatornillar los montaje tornillo de fijación

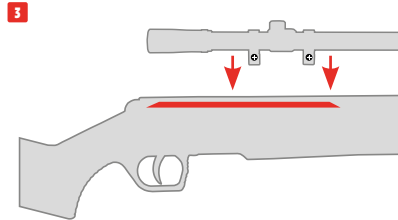

- EN** Mount
- DE** Aufsetzen
- FR** Appliquer
- ES** Fijar

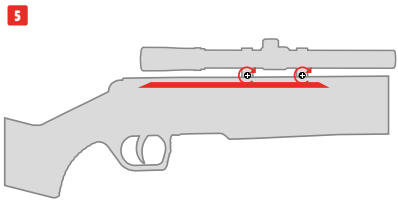
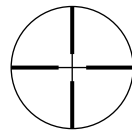
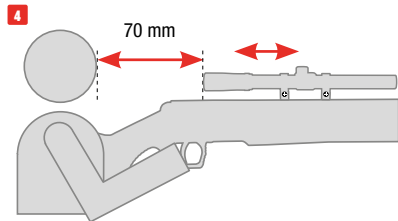

- EN** Tighten the fixing screws
- DE** Fixierschrauben festziehen
- FR** Visser les vis de fixation
- ES** Atornillar los tornillos de fijación

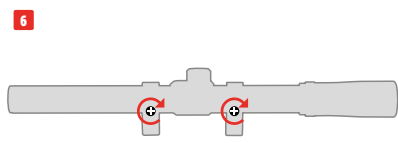

- EN** Tighten the 2 tube lug screws
- DE** Die 2 Tubus-Fixierschrauben festziehen
- FR** Visser les 2 tube vis de fixation
- ES** Atornillar los 2 Tubo tornillo de fijación



## MOUNTING | MONTAGE | MONTAJE | MONTAGE

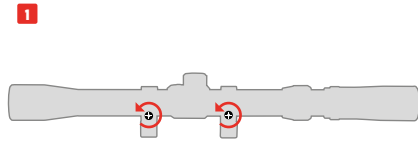

- EN** Slightly loosen the 2 tube lug screws
- DE** Die 2 Tubus-Fixierschrauben leicht lösen
- FR** Dévisser légèrement les 2 tube vis de fixation
- ES** Desatornillar ligeramente los 2 Tubo tornillo de fijación

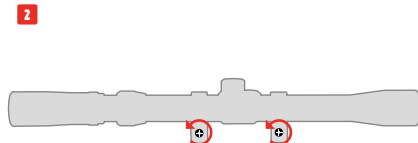

- EN** Unscrew lug screws
- DE** Fixierschrauben lösen
- FR** Dévisser les vis de fixation
- ES** Desatornillar los tornillos de fijación

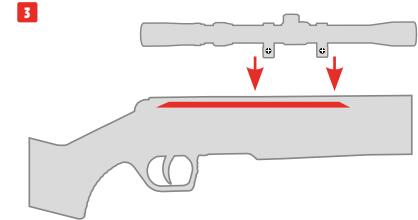

- EN** Mount
- DE** Aufsetzen
- FR** Appliquer
- ES** Fijar

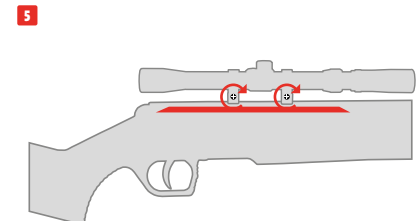
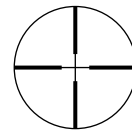
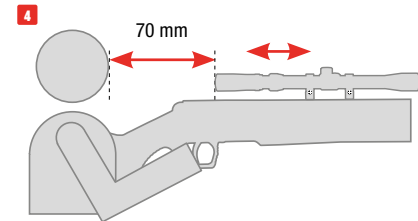

- EN** Tighten the fixing screws
- DE** Fixierschrauben festziehen
- FR** Visser les vis de fixation
- ES** Atornillar los tornillos de fijación

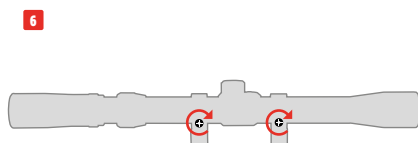

- EN** Tighten the 2 tube lug screws
- DE** Die 2 Tubus-Fixierschrauben festziehen
- FR** Visser les 2 tube vis de fixation
- ES** Atornillar los 2 Tubo tornillo de fijación



## OPERATING INSTRUCTIONS RIFLESCOPE



# 4x15/4x20/3-7x20

[WWW.UMAREX.COM](http://WWW.UMAREX.COM)

**EN** We reserve the right to make color and design changes and technical improvements. No responsibility is accepted for printing errors or incorrect information. **DE** Änderungen in Farbe und Design sowie technische Verbesserungen, Druckfehler und Irrtum vorbehalten. Alle Angaben ohne Gewähr. **FR** Sauf modifications de la couleur et du design ainsi que des améliorations techniques, erreurs d'impression et erreur. Toutes les données sont fournies sans garantie. **ES** Salvo modificaciones de color y de diseño así como mejoramientos técnicos, erratas y error. Todos los datos sin garantía.

UMAREX GmbH & Co. KG • Donnerfeld 2 • 59757 Arnsberg • Germany • [service@umarex.de](mailto:service@umarex.de)