

WORK SHARP® KNIFE & TOOL SHARPENER KEN UNION EDITION BLADE GRINDING ATTACHMENT



Video Demos and Replacement Belts Available at:

WORKSHARPTOOLS.COM

SAFETY INFORMATION:

Use only as directed in Work Sharp User's Guide.

WARNING: To minimize the risk of injury, always use proper eye and respiratory protection. Use only as directed in Work Sharp User's Guide.

WARNING! CHOKING HAZARD!
Small Parts - Not for children under 3-yrs.

WARNING: This product contains a chemical known to the State of California to cause cancer. Some dust created by power sanding and grinding as well as contents from the machine may contain chemicals known to the State of California to cause cancer, birth defects or other reproductive harm.

Darex, LLC
210 E. Hersey St.
Ashland OR 97520
USA

Telephone: 1 (800) 597-6170

Fax: 1 (541) 552-1377

E-mail: techsupport2@darex.com

Internet: www.worksharptools.com

INSTALLATION:

1 Push lock release lever & rotate knife sharpening cassette to remove cassette.



2 Install Blade Grinding Attachment by aligning the chassis to the keyed "on / off" position then rotate into the "sharpening position".



3 Install Hub Fastener onto drive shaft.



Remember: Counter-clockwise to tighten, clockwise to loosen.

4 Push in and turn tensioner clockwise to install / uninstall belt.

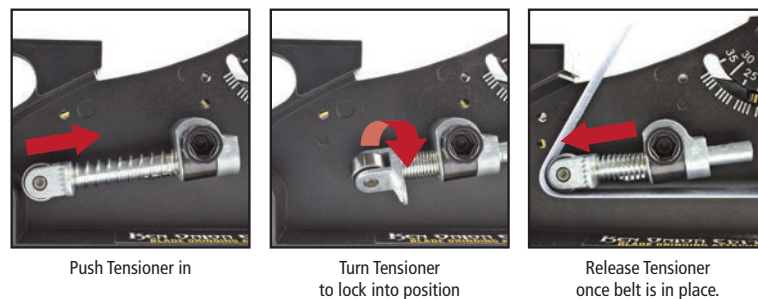

GET TO KNOW YOUR TOOL:

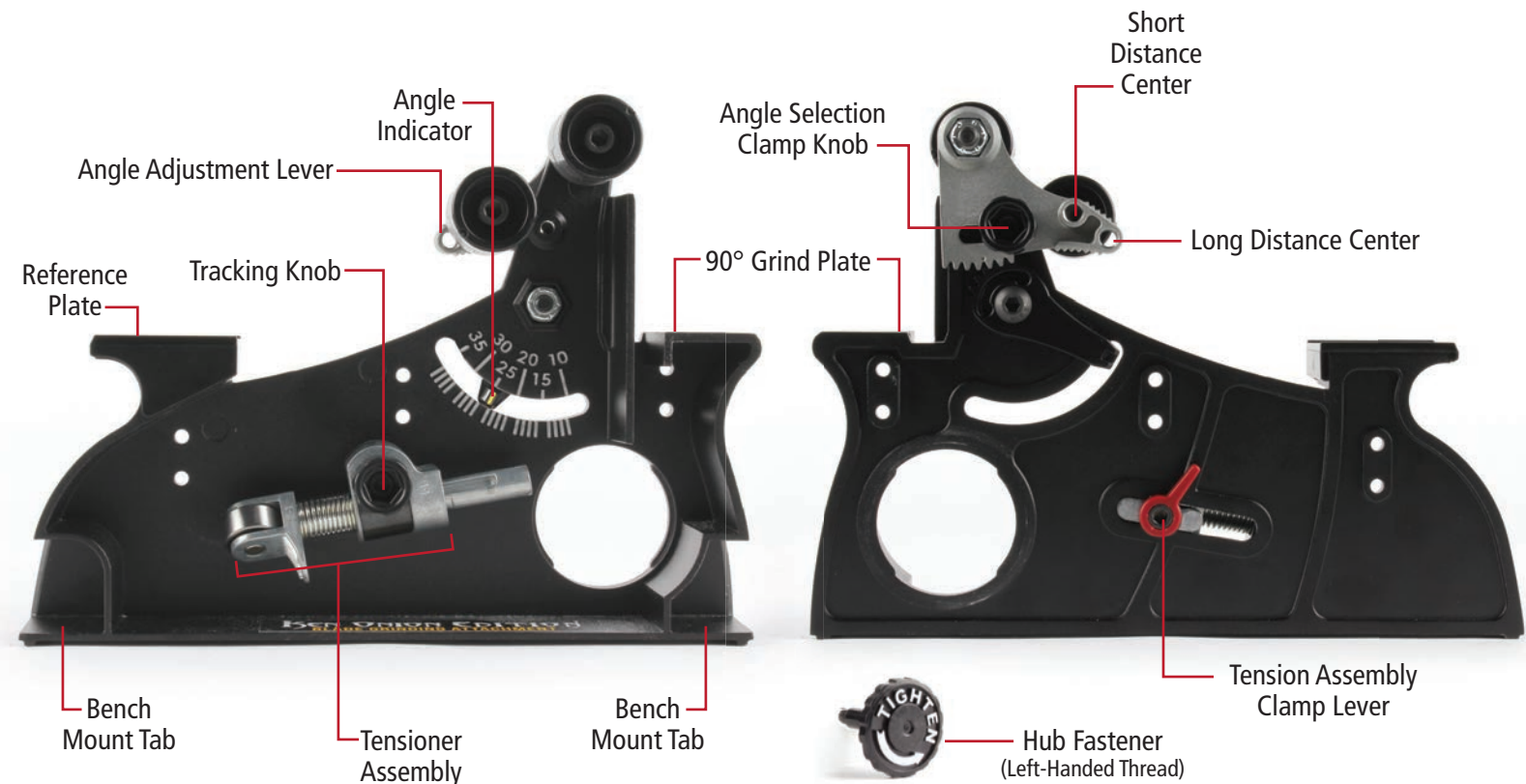

5 Use tracking knob to center belt on pulley.

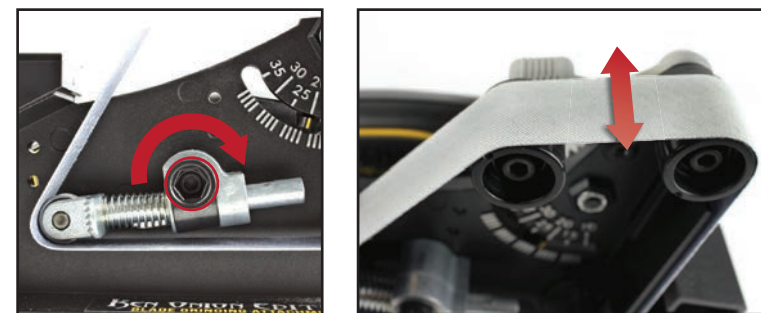

Optional: Use a clamp to secure to work bench.



BELT INFORMATION:

Included 1" X 18" belts are listed below. Replacement Belt Kits (WSSAK081115) are available at select retailers and WorkSharpTools.com.

	Grit: X65 Grit Coarse Size: Norax 65µ Use: Shape
	Grit: X22 Grit Medium Size: Norax 22µ Use: Sharpen
	Grit: X4 Grit Fine Size: Norax 4µ Use: Hone
	Grit: 12000 Grit Extra Fine Size: SiC 1µ Use: Strop

For reference, belts are equivalent to: X65 (P220) | X22 (P1000) | X4 (P3000)

TOOL SET UP:

- 1 Choose either short or long center location for pulley depending on preference.

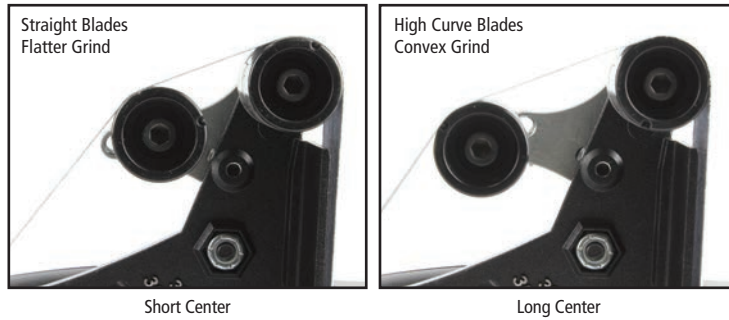

- 2 Set the desired sharpening angle, set tensioner into lock position, then move the Angle Adjustment Lever. Tighten Angle Selection Clamp Knob to secure selected angle.

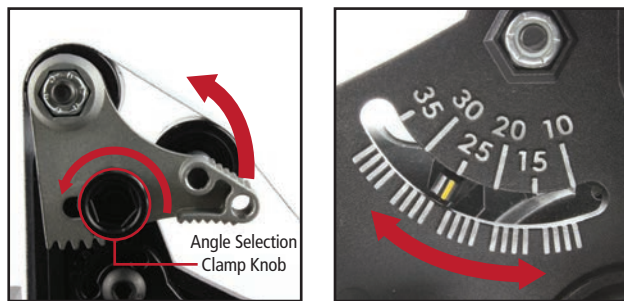

BEST TECHNIQUES:

Be mindful that accommodations will need to be made for every blade such as thumb studs, pocket clips, blade profile or handle design. Test run the blade through the process on both bevels without power first to ensure accommodations can be made before sharpening.

Do not over-tension belt or it may negatively affect belt tracking. If Over-Tension Mark is visible, lower tension.

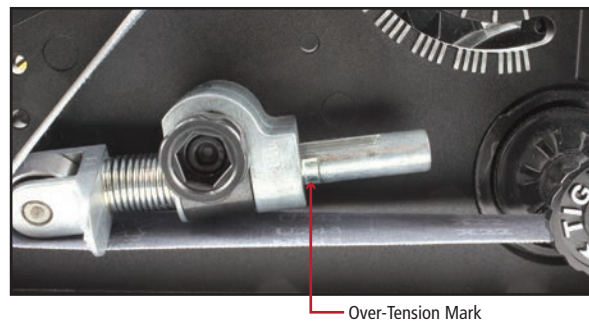

Use a clamp to secure to work bench.

During heavy grinding, do not over-heat the blade.

- 3 Choose and mount a belt based on the task at hand (see Belt Information Section for details).

- 4 Turn on power at medium speed and press switch lock out button.

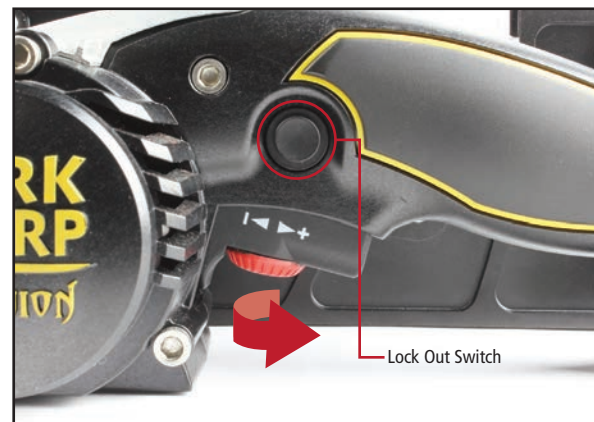

- 5 Ensure belt is properly tracking so it is centered on the pulleys.

The tool is ready for use. Continue to Sharpening Section.

Sharpening Process:

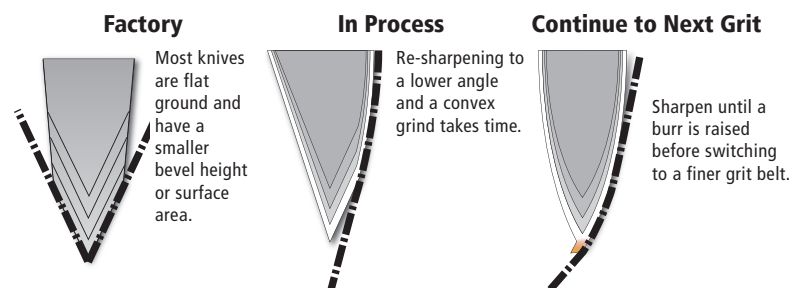

- Follow the curve of the knife when sharpening for best results.

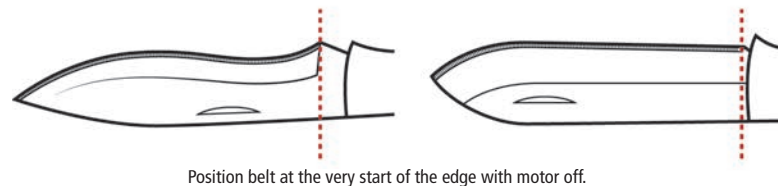

- Follow the curve of the knife when sharpening for best results.

- Masking tape can protect blade from scratching during sharpening.

- Use a practice knife to learn.

SHARPENING:

- 1 Place spine of the blade flat onto reference plate. While keeping blade flat, move up onto belt surface and place the heel of the blade edge onto the abrasive.



Use very light pressure on belt (1/16" deflection).

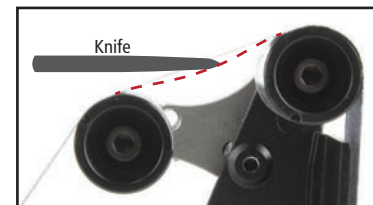

- 2 Move blade flat across abrasive (1" per second) and stop the tip on the middle of the belt. Then pull blade away from the belt.



TROUBLESHOOTING:

Knife not getting sharp?

- More strokes** - Grind all the way to the edge. Continue until a burr is raised. Then progress to a finer belt.
- Higher Speed** - Slow belt speeds may not be removing enough material.
- Coarser Belt** - Coarser grit belts will remove material more aggressively.

a) Problem: The tips of my knives are becoming rounded.

Solution 1: Stop the tip on the belt.

Solution 2: Keep the blade edge perpendicular to the belt. To reduce tip rounding, follow the curve of the blade.

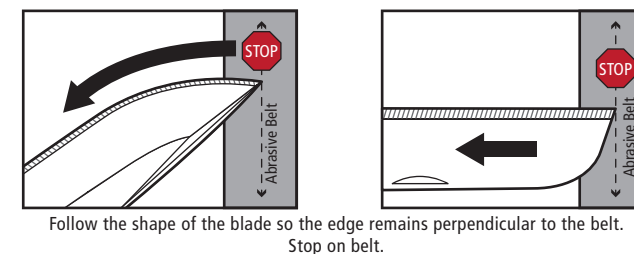

c) Problem: How do I feel for a burr at the cutting edge to know when to proceed to a finer belt?

Solution: Slide your finger perpendicular and away from the cutting edge. The burr will feel like a small 'ridge' or 'wire' at the edge.

See image in the Sharpening Section, Step 3.

- 3 Continue sharpening the same side of the blade until a burr is raised along entire edge (count strokes).



- 4 Repeat same number of strokes on other side of blade.

- 5 Continue up the grit scale until desired sharpness is achieved. Ensure tracking and tension is properly set when you change belts.

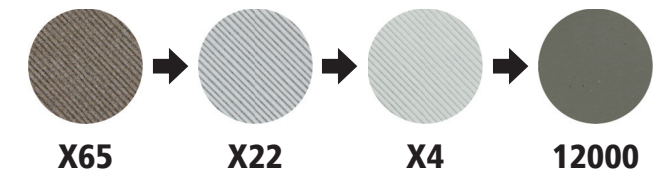

ACCESSORY LIST:

- WSKTS-KO Blade Grinding Belt Kit** (1" x 18" belts): WSSAK081115
- Individual Extra Coarse P120 Grit Belt** (1" x 18" belts): PP0002770
- Individual Coarse X65 Grit Belt** (1" x 18" belts): PP0002940
- Individual Medium X22 Grit Belt** (1" x 18" belts): PP0002942
- Individual Fine X4 Grit Belt** (1" x 18" belts): PP0002943
- Individual Extra Fine 12,000 Grit Belt** (1" x 18" belts): PP0002952
- Leather Belt Kit** (1" x 18" belts with .5μ compound): WSSA0002782

WARRANTY:

1-year warranty on all **WORK SHARP®** components; excludes abrasives. Warranty for consumer not industrial use.