

## LENS REMOVAL

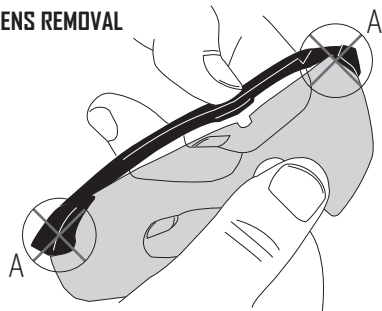

- 1) Remove nose piece [see nose piece removal].
- 2) With one hand firmly grasp the frame directly above the nose piece. Do not pull from the edges [Ref A].
- 3) With the opposite hand grasp the lens.

## LENS REMOVAL

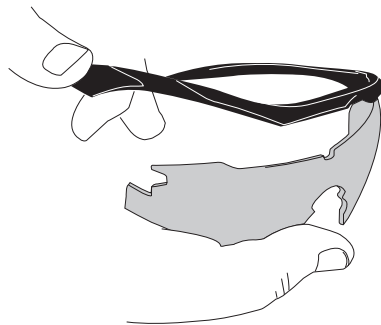

- 4) Firmly pull on the lens to detach the lens from the center of the frame.
- 5) Detach the outer lens hooks from the frame.

**Note:** Pulling lenses from the corners of the frames [See "A"] may damage the frame or the lenses.

## LENS INSTALLATION

- 1) Attach outer corners of lens into frame.

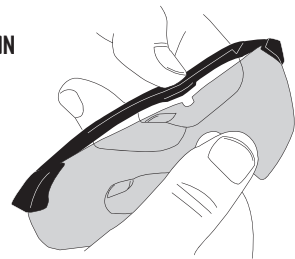

- 2) Align center lens slot into center catch of the frame.
- 3) Squeeze the lens and frame together.

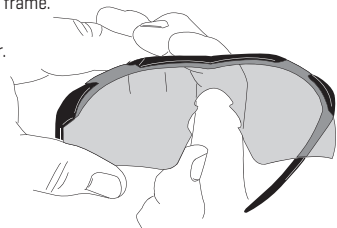

**MAINTENANCE:** Wiley X lenses are specially coated to offer superior abrasion resistance. Please follow below instructions to prolong the life of your lenses and keep them performing at their best:

- Clean lenses with water only.
- Do not use solvents or special cleaners.
- Use micro-fiber cleaning cloth provided to gently wipe clean.
- Never use paper products to clean and avoid wiping lens surface when dry and/or dirty as this may potentially scratch the lens.

**WARNING:** Wiley X brand eyewear is tested tough. However, impact resistant eyewear is not unbreakable and does not provide unlimited eye protection under all circumstances and conditions. Misused, abused, scratched and/or damaged eyewear can reduce impact protection (and void your warranty). Dirty and/or wet eyewear can impair vision and reduce safety (resulting in personal injury and/or property damage). Keep your Wiley X eyewear clean as indicated above. Store your Wiley X eyewear in the protective case provided to prolong the life of the lenses. Most of all, take all appropriate precautions when wearing your Wiley X eyewear during hazardous and/or dangerous activities and conditions. Wiley X, Inc. is not responsible for personal injury, property damage or losses incurred while using Wiley X brand products.



**WILEY X INC: 1.800.776.7842 // 925.243.9810 // WILEYX.COM**  
 7800 PATTERSON PASS ROAD, LIVERMORE CA 94550 USA  
**WILEY X EUROPE LLC: +45 96 93 00 45 // WILEYX.EU**  
 SØNDERGADE 8-10 7570 VEMB DENMARK

**COPYRIGHT © 2022 WILEY X, INC. ALL RIGHTS RESERVED.**

WILEY X, WX, BLACK OPS, logos, tag lines and product names are trademarks or registered trademarks (marcas registradas) of Wiley X, Inc. in the U.S. and other countries. Logos © 2007-2022 Wiley X, Inc. All rights reserved.

ERX-ICSHIELD



# SHIELD STYLE INSTRUCTIONS

## NOSE PIECE INSTALLATION

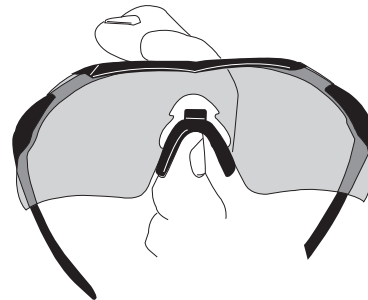

1) Align grooves of nose piece into the lens.

**\*Should you require corrective lenses, remove the Rx insert prior to removing the nosepiece. See Rx insert instruction.**

## NOSE PIECE INSTALLATION

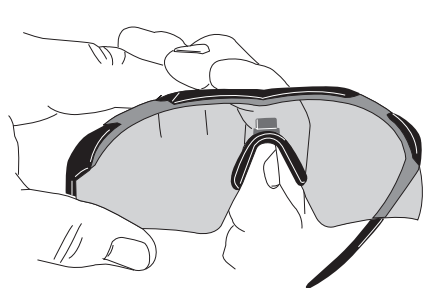

2) Position hand as pictured and squeeze together until the nose piece completely seats into the lens.

## INSTALLING THE TWIST LOCK CARRIER TO THE RX ADAPTOR\*

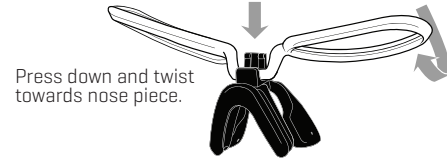

Press down and twist towards nose piece.

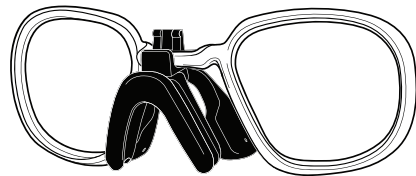

## INSTALLING THE UPLC CARRIER TO THE RX ADAPTOR\*



Press the Rx carrier center slot onto the Rx Adaptor post.

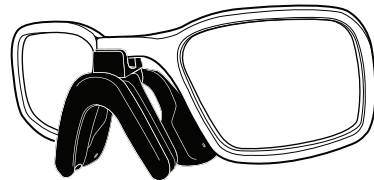

## INSTALLING THE PTX CARRIER

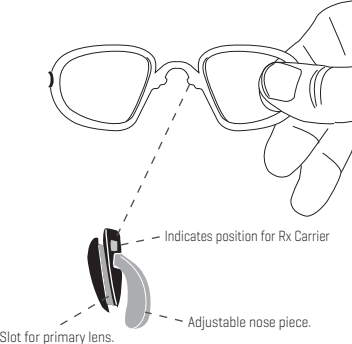

Slot for primary lens.

Adjustable nose piece.

The prescription carrier is held in place by aligning the buds on the Rx carrier into the notches on the nose piece.