

PARD



User Manual

Digital Night Vision
NV007V2

Important Reminder

1 All PARD products are exclusively designed for civilian use and strictly prohibited for any military purposes.

2 All PARD products are not authorized for export to, including but not limited to Russia, Belarus, Palestine, Israel, Sudan, South Sudan, and other conflict zones.

Scan To Enjoy Privilege



Scan The QR Code to Join Our Membership

- 1 Extend warranty
- 2 Enjoy 1 on 1 expert service
- 3 Get the product experience officer opportunity

CONTENTS

INTRODUCTION.....	2
PRECAUTIONS	2
PACKAGE CONTENTS	3
DESCRIPTION & KEY FEATURES.....	3
SPECIFICATIONS.....	4
INSTALLATION	7
OPERATION INSTRUCTION	11
FCC WARNING.....	20

INTRODUCTION

Thank you for choosing the PARD NV007V2 night vision clip-on device. Please read this manual carefully before using the device to ensure proper and safe operation. Please keep this manual in a safe place for future reference. It provides step-by-step instructions for using your night vision scope.

This manual is for reference purposes only and may be subject to updates without prior notice. For the latest information, please visit PARD's official website. PARD reserves the final right to interpret this manual.

PRECAUTIONS

- **Battery Usage:** Please remove the insulating tape from the battery before first use. Use a fully charged lithium-ion battery with a voltage rating of 3.7V.
- **Device Storage:** Turn off the device and remove the battery if not use for more than 10 days. Store the device & battery in a dry and safe place.
- **Handling and Transportation:** Exercise caution when handling or transportation the device. It is recommended to use the original packaging for transportation.
- **Light Exposure:** Do not use the device to focus directly on strong sources of light such as the sun or electric welding. Direct exposure may damage the detector and void the warranty.
- **Lens Protection:** Prevent lens scratches and damage from oil or chemical contamination. Keep the lens cap on when not in use.
- **Environmental Considerations:** Place the device in a cool, dry, and well-ventilated environment. Avoid strong electromagnetic fields. Ensure the storage temperature remains between -30°C /-22 °F and 50°C /122 °F .
- **Device Disassembly and Support:** Please refrain from attempting to disassemble the device without proper authorization. Unauthorized disassembly can result in voiding the warranty and may cause irreparable damage to the device. If you encounter any problems, please contact our after-sales team. Report any issues promptly to ensure timely resolution and proper support.
- **Attention! Export Requirements:** Please note that all PARD night-vision and thermal imaging devices require a license for export outside the country.

PACKAGE CONTENTS

No.	Contents	Quantity
1	NV007V2 Digital Night Vision Clip-on	1
2	3.7V 18650 Rechargeable lithium-ion battery	1
3	Adapter	1
4	Gasket	3
5	Type-C cable	1
6	Allen wrench	2
7	Insulating tape	1
8	Rubber O rings	2
9	User's manual	1
10	Warranty card	1

DESCRIPTION & KEY FEATURES

NV007V2 is a back mounted digital night vision clip-on and the latest addition to the NV007 series, featuring a high sensitivity 2K CMOS sensor and advanced clear HD display. Its low-illumination and high-sensitivity sensor enable hunters to effectively extend their hunting hours well in the night. With its impressive 6000J impact resistance which ensures reliable performance. Equipped with a rechargeable 18650 lithium battery, it offers convenience, ease of use, and long-lasting operation.

Key features

- Extremely sensitive 2560*1440 CMOS Image Sensor
- 1440*1080 Display resolution
- Visible Light Enhancement Algorithm (VLEA)
- Adjustable IR illuminator
- WiFi
- 6000J recoil resistance

SPECIFICATIONS

Model		NV007V2	
Resolution(pixel)		2560*1440	
Sensitivity(Lux)		0.001	
Frame Rate(Hz)		60(color)/30(B&W)	
Objective Lens(mm)		14.5	
Optical Magnification(x)		1.4	
Digital Zoom(x)		1.5-3.5	
Field of view	Horizontal	22°	
	Vertical	12°	
	Diagonal	27°	
Focus Range		3cm-∞	
General Parameters			
Display Type	OLED	Display Resolution(pixel)	1440*1080
Eye Relief(mm)	25	Image Mode	Color/B&W
IR Power(w)	5	Diopter Adjustment(D)	±5D

IR Illuminating Level	3 Levels	IR Distance	350
Photo Resolution(pixel)	1440*1080	IR Wavelength(nm)	850/940
Video Resolution(pixel)	1440*1080	Photo format	.JPG
Storage (GB)	Micro SD card(< 128G)	Video Format	MP4
Auto recording	Yes	Record Audio	Yes
Time Stamp	Yes	Loop-recording	Yes
USB Type-C	Yes	HDMI Output	Yes
WiFi	Yes	Exposure	Yes
Battery Type	18650 Li-ion Battery	Support Apps	PardVision2
Output Voltage(V)	3.7	Operating time(h)	≤6h
Recoil Resistance(J)	6000	Operating temp(°C)	-30°C ~50°C
Product Dimension(L x W x H, mm)	135*55*100	N.W/pcs(with/without battery, g)	275/229

COMPONENTS

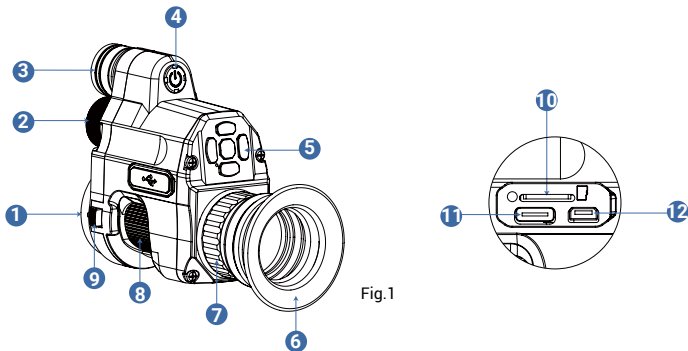

Fig.1

No.	Name	No.	Name
1	Objective lens	7	Diopter focusing ring
2	Battery compartment cap	8	Objective lens focusing ring
3	IR illuminator	9	Adapter lock
4	Power/Sleep button	10	Micro SD card slot
5	Keypad	11	Type-C charging port
6	Rubber eye cup	12	HDMI port

INSTALLATION

1. Unboxing

Before using this device, please follow these steps:

- Open the box and carefully remove the device.
- Verify that all items listed in the package contents are included in the box.
- Inspect the device for any signs of damage to the display, body, lens, buttons, and other components.
- Ensure that the objective lens and eyepiece are clean and in proper working condition.

Note: If you find any accessories missing or damaged, please contact our after-sales service for assistance.

2. Battery Installation and Startup

Please following the steps below for battery installation:

- (1) Turn the battery cap counterclockwise to open it and remove the battery.
- (2) Remove the insulating tape from the battery.

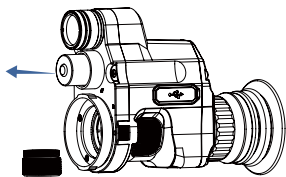

Fig.2



Fig.3

(3) Insert the battery with the positive pole (+) facing inward, then rotate the battery cap clockwise until it is tightly locked in place.

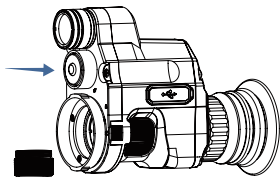

Fig.4

(4) To power on the device, press and hold the power button for approximately 3 seconds. The device is ready for use when the PARD Logo appears on the screen.

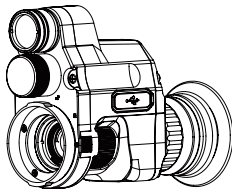

Fig.5

Note:

- Use a single 18650 rechargeable lithium-ion battery with a voltage rating 3.7V;
- Do not expose the battery pack to high temperature or to a naked flame.
- Do not put the device into water when the battery cover is open;
- Do not expose disassemble the device without authorization;
- Do not pierce the device with sharp objects;
- Battery should be kept out of reach of children, and the positive and negative terminals of the battery should be installed correctly;
- While charging the battery do not leave the battery unattended.
- When using the battery at cold(low) temperatures, the battery capacity decreases, this is normal and not a defect.
- Do not use the battery if it has been damaged in any way.
- After charging is complete do not leave the battery on charge connected to the network.



Please act responsibly and recycle or dispose of all used batteries according to the law.

3. Adapter Installation

To ensure optimal performance and user experience, we highly recommend using our original adapter provided in the product packaging as shown in Fig. 6.

The adapter installation steps are as follows:

- Remove the digital night vision device, adapter, gaskets and Allen wrench from the box.
- Before installing the adapter, turn on the device to see the clear icons on screen.
- Apply 1-2 layers of insulating tape to protect the day light scope's ocular lens.
- Attach the adapter to the objective lens of the device and turn it clockwise until hearing a "click" sound.
- Choose the right gasket(s) for your day light scope's eyepiece diameter. Attach the device to the scope's eyepiece bell.
- Secure by tightening the adapter locking lever.

Note: When disassembling, press the adapter lock, rotate the adapter counterclockwise, and remove it.(Fig.7)

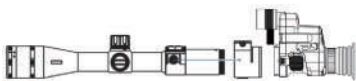

Fig.6

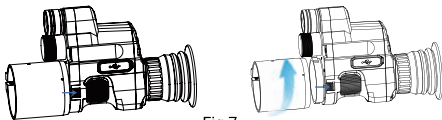

Fig.7

4. Focusing

Diopter Adjustment Ring

Diopter adjustment in a night vision device refers to the ability to adjust the focus of the device's eyepiece to compensate for differences in users' vision. It allows individuals with varying levels of eyesight to achieve a clear and focused view of the displayed content on the device's screen.

- After turning on the device, rotate the diopter adjustment ring until the texts or icons on the screen are clearly.
- Please note that the image may not be clear after diopter adjustment. As long as the text on the screen is clear and visible, it is sufficient.

Note: If the objective lens is not properly focused, the image may be unclear.

Objective Lens Adjustment Ring

- Before adjusting the objective lens, it is important to complete the diopter focusing.
- Then adjust the objective lens focus ring until a clear image of the target is achieved.

5. Reticle Center Position Adjustment

When you enter the submenu, an auxiliary crosshair will appear on the screen to represent the center position of the image. Adjust the values of "X" and "Y" on the display screen to move the center position of the image, the crosshair of the day optical scope will be displayed at the center point of the screen.

Interface Explanation



Fig.8

- Press [Key 4] enter menu mode, press [Key 1]/[Key 5] to move the cursor to Reticle Center Position Adjustment, and press [Key 3] to enter the submenu.

- Press [Key 2]/[Key 4] to adjust the position of the "X" axis, and press [Key 1]/[Key 5] to adjust the position of the "Y" axis until the center of the auxiliary crosshair on the display screen aligns with the center point of the crosshair of the day optical scope.
- After confirming that the two crosshairs are aligned, press [Key 3] to save and return to the home screen, and the auxiliary crosshair will no longer be displayed on the screen.

OPERATION INSTRUCTION

Interface

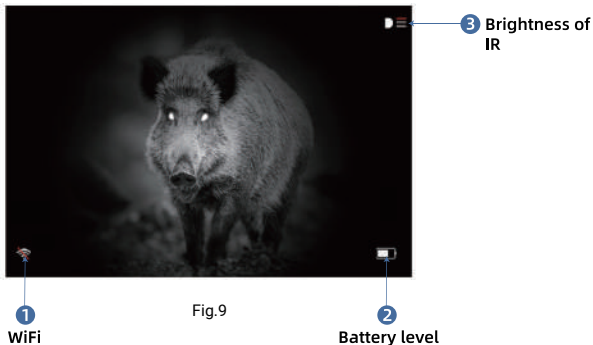

Fig.9

Shortcut Mode

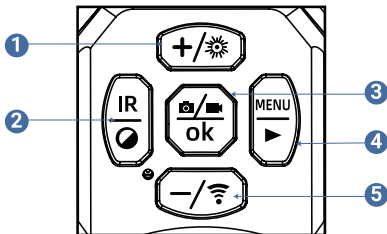

Fig.10

Keypad	Single Press	Press and Hold
1	Up	/
2	IR light level adjustment	Switch black & white/Color mode
3	Take a photo/OK/Play back	Record video/Save video
4	Menu/Back	Files/Back
5	Zoom in/Down	Turn on/off WiFi
Power Key	Power/Sleep button	Power on/off

Explanation:

Key 1:

1.Single press:

- **Menu mode:** press [Key 1] in the menu mode to scroll up and adjust the relevant option settings.

Key 2:

1.Single press:

Home screen mode: press [Key 2] to turn on the first, second and third level of brightness of the IR light (you need to enter the black and white mode before you can perform this operation.)

2.Press and hold:

Home screen mode: press and hold [Key 2] to switch between black and white/color mode.

Key 3:

1.Single press:

- **Home screen mode:** press [Key 3] to take photo;
- **In the menu mode:** press [Key 3] to confirm your selection.

2.Press and hold:

Home screen mode: press and hold [Key 3] to record video. Press and hold [key 3] again to save the video and exit.

Key 4:

1.Single press:

- **Home screen mode:** press [Key 4] to enter the menu interface.
- **Menu mode:** press [Key 4] to return to the home screen page.

2.Press and hold:

Home screen mode: press and hold [Key 4] to enable the playback function. After entering this interface, the video and picture files stored on the memory card will be displayed.

- Press [Key 1]/[Key 5] to switch between files.
- Press [Key 3] to play/pause the saved videos.
- When playing videos, press [Key 1]/[Key 5] to fast forward or rewind 2x/4x/8x times.
- Press [Key 4] to access the following settings.

(1) Delete: <ul style="list-style-type: none"> ● Delete Current ● Delete All 	(2) Protect: <ul style="list-style-type: none"> ● Lock Current ● Unlock Current ● Lock All ● Unlock All 	(3) Slide Show: <ul style="list-style-type: none"> ● 2 seconds ● 5 seconds ● 8 seconds
--	---	---

- Press and hold [Key 4] to return the home screen.

Key 5:

1.Single press:

- **Home screen mode:** press [Key 5] to switch the magnification.
- **menu mode:** press [Key 5] to scroll down between menu options.

2.Press and hold:

Home screen mode: press and hold [Key 5] to turn on/off WiFi.

Note: When the WiFi is turned on, you cannot access the menu. Press and hold the [Key 5] to turn off WiFi and then enter the menu interface.

Key 6(Power Key):

1.Single press:

Click it to enter sleep mode, and click again to exit sleep mode;

2.Press and hold:

Press and hold the power button for 3 seconds to power on/off the device;

Functions

Home screen mode: press [key 4] to enter the menu mode, where you can set various function options within the menu bar. Please note that the shortcut key function is disabled in this mode (Fig. 11).



Fig.11

1. Reticle Center Position Adjustment

Reticle adjustment refers to adjusting the center of the night vision device. This ensures that the central point of the device is consistent with the optical crosshair.



Fig.12

- Press [Key 4] enter menu mode, press [Key 1]/[Key 5] to move the cursor to reticle center position adjustment, and press [Key 3] to enter the sub-menu.
- Press [Key 2]/[Key 4] to adjust the position of the "X" axis, and press [Key 1]/[Key 3] to adjust the position of the "Y" axis until the center of the auxiliary crosshair on the display screen aligns with the center point of the crosshair of the day optical scope.
- After confirming that the two crosshairs are aligned, press [Key 3] to save and return to the home screen, and the auxiliary crosshair will no longer be displayed on the screen.

2. Default Color

There are 2 built-in color modes, "Color"/ "Black & White". Users can choose their preferred color settings.

- Press [Key 1]/[Key 5] to move the cursor to default color setting option, and press [Key 3] to enter the sub-menu.
- Press [Key 1]/[Key 5] to select "Color"/ "Black & White".
- Press [Key 3] to save and return to the previous page.

3. Brightness of IR

This function allows you to adjust the brightness of IR illuminator.

- Press [Key 1]/[Key 5] to the brightness of IR option. Press [Key 3] to enter the sub-menu interface;
- Press [Key 1]/[Key 5] to select among "Off", "1", "2","3"option and then press [Key 3] to save and return to the previous page.

4. Display Brightness

This function allows you to adjust the brightness of the screen.

- Press [Key 1]/[Key 5] to display brightness option. Press [Key 3] to enter the sub-menu interface.
- Select "0", "Level 1", "Level 2", "Level 3", "Level 4", "Level 5", "Level 6" or "Level 7" by pressing [Key 1]/[Key 5].

5. Auto Recording

Once this function is enabled, the device will initiate automatic recording and continue this operation after the next power-on.

- Press [Key 1]/[Key 5] to the auto recording option. Press [Key 3] to enter the sub-menu.
- Press [Key 1]/[Key 5] to select "Off" or "On" options, and then press [Key 3] to save and return to the previous page.

6. Loop Recording

Users can customize the segment recording duration by accessing the loop recording settings. When the memory card reaches its full capacity, new recordings will automatically overwrite the previously saved files. Selecting "Off" will stop recording when the memory card is full, and the oldest video file will not be overwritten.

- Press [Key 1]/[Key 5] to the loop recording option. Press [Key 3] to enter the sub-menu.
- Press [Key 1]/[Key 5] to select "Off", "1 Min", "3 Min", "5 Min" or "10 Min" and then press [Key 3] to save and return to the previous page.

7. Date Stamp

Users can customize the display of a time stamp in the lower right corner of captured photos and videos.

- Press [Key 1]/[Key 5] to the date stamp option. Press [Key 3] to enter the sub-menu;
- Press [Key 1]/[Key 5] to select "Off" or "On" options, and then press [Key 3] to save and return to the previous page.

8. Record Audio

Users can customize the display of a time stamp in the lower right corner of captured photos and videos.

- Press [Key 1]/[Key 5] to the record audio option. Press [Key 3] to enter the sub-menu;
- Press [Key 1]/[Key 5] to select "Off" or "On" options, and then press [Key 3] to save and return to the previous page.

9. WiFi

Through the WiFi connection, you can use your phone, PC or tablet as an external viewfinder enabling users to synchronously see the photos and videos on a larger screen.

- Press [Key 1]/[Key 5] to the WiFi option. Press [Key 3] to enter the sub-menu;
- Press [Key 1]/[Key 5] to select "Off" or "On" options. Choose "Off" and press [Key 3] to save and go back to the previous page. Select "On" to enable Wi-Fi and return to the home screen.

Steps to connect to your mobile device:

- Download "PardVision 2" from the Apple App Store or the Google Play Store.
- Enable Wi-Fi on both your device and your mobile device.
- Search for the Wi-Fi network on your mobile device (the device Wi-Fi network is a string of characters starting with PARD, which is a unique string of numbers). Please enter the password: 12345678 to connect.
- Enter the application to operate and use.

Note: After enabling Wi-Fi, you cannot access the menu. Press and hold [Key 4] to disable the Wi-Fi and then enter the menu interface.

10. Exposure

Users can choose their preferred exposure settings.

- Press [Key 1]/[Key 5] to the exposure option. Press [Key 3] to enter the sub-menu;
- Use [Key 1]/[Key 5] to select your preferred option, and then press [Key 3] to save and return to the previous page.

11. Language

Users can choose their preferred language.

- Press [Key 1]/[Key 5] to the language option. Press [Key 3] to enter the sub-menu;
- Press [Key 1]/[Key 5] to your preferred language and then press [Key 3] to save and return to the previous page.

12. Date/Time

Users can set the system date and time of the device.

- Press [Key 1]/[Key 5] to the date/time option. Press [Key 3] to enter the sub-menu;
- Press [Key 1]/[Key 5] to adjust the date and time value, and then press [Key 3] to switch options. Press [Key 4] to return to the previous page.

13. Format

Please note that reformatting the Micro SD Card will permanently delete all data, and it cannot be recovered. Please operate with caution!

- Press [Key 1]/[Key 5] to the format option. Press [Key 3] to enter the sub-menu;
- Press [Key 1]/[Key 5] to select "Cancel" or "OK" option. After selection, press [Key 3] to confirm the relevant operation and return to the previous page.

14. Default Setting

Resetting the device will restore it to the factory default settings, deleting all user data and personalized settings. Proceed with caution when performing this operation!

- Press [Key 1]/[Key 5] to the default setting option. Press [Key 3] to enter the sub-menu;
- Press [Key 1]/[Key 5] to select "Cancel" or "OK" option. After selection, press [Key 3] to confirm the relevant operation and return to the previous page.

15. Version

This function displays the device's version.

- Press [Key 1]/[Key 5] to the version option. Press [Key 3] to enter the sub-menu;
- Press [Key 3] again to return to the previous page.

FCC WARNING

This device complies with part 15 of the FCC Rules. Operation is subject to the following two conditions:

- (1) This device may not cause harmful interference, and
- (2) this device must accept any interference received, including interference that may cause undesired operation.

Note: This equipment has been tested and found to comply with the limits for a Class B digital device, pursuant to part 15 of the FCC Rules. These limits are designed to provide reasonable protection against harmful interference in a residential installation. This equipment generates, uses and can radiate radio frequency energy and, if not installed and used in accordance with the instructions, may cause harmful interference to radio communications. However, there is no guarantee that interference will not occur in a particular installation. If this equipment does cause harmful interference to radio or television reception, which can be determined by turning the equipment off and on, the user is encouraged to try to correct the interference by one or more of the following measures:

- Reorient or relocate the receiving antenna.
- Increase the separation between the equipment and receiver.
- Connect the equipment into an outlet on a circuit different from that to which the receiver is connected.
- Consult the dealer or an experienced radio/TV technician for help.

Note: The Grantee is not responsible for any changes or modifications not expressly approved by the party responsible for compliance. such modifications could void the user's authority to operate the equipment. The device has been evaluated to meet general RF exposure requirement. This equipment complies with FCC's RF radiation exposure limits set forth for an uncontrolled environment. This device and its antenna(s) must not be co-located or conjunction with any other antenna or transmitter.

Follow Us



@pardusaofficial



@pard_usa



@PARDusa



Please Search and follow our channel for more information

Website

www.pard.com

Business Cooperation

sales.support@optimaxtechnologyllc.com

Service Center

support@pard-tech.com

PARD

Tell: +1 (800) 986 4370

Add: 3500 Lakeside Court, Suite 101, Rm 122,
Reno, NV 89509

